

**SUITE I, 6TH FLOOR  
BERKELEY SQUARE HOUSE  
BERKELEY SQUARE  
LONDON W1J 6BS**



[www.ps2property.co.uk](http://www.ps2property.co.uk)



**OFFICE TO LET  
4,596 SQ FT  
(426.9 SQ M)**



# Office to Let

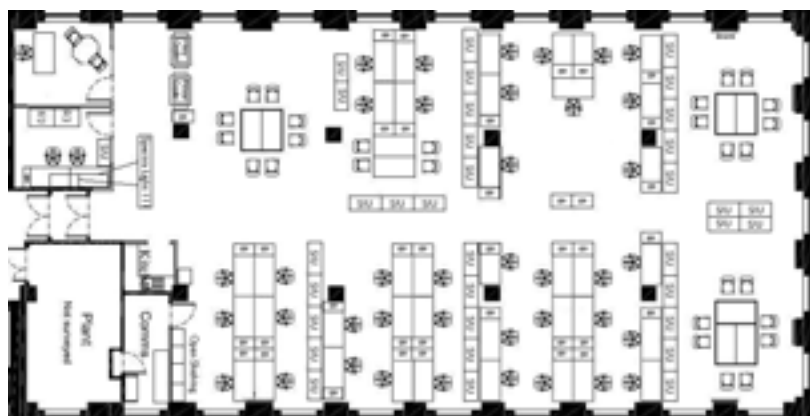

## OFFICE

SUITE I  
6TH FLOOR  
BERKELEY SQUARE HOUSE  
BERKELEY SQUARE  
LONDON  
W1J 6BS

### LOCATION

Berkeley Square House is undoubtedly one of London's most prestigious office addresses. Located in the heart of Mayfair, Berkeley Square offers immediate access to London's finest hotels, world class shopping facilities and private clubs. Transport facilities in the immediate area are unrivalled with Bond Street, Green Park and Oxford Circus underground stations in close proximity. Major bus services are located on Piccadilly and Oxford Street.

### DESCRIPTION

Berkeley Square House is distinguished as one of the premier multi-occupied buildings in Mayfair. The building provides over 350,000 sq ft of office accommodation accessed via a stunning double height manned reception with the added benefit of a further manned reception on Bruton Street.

The suite provides good quality, open plan fitted office accommodation benefiting from natural light on three sides. The suite was refurbished in 2005 and offers VAV air conditioning, suspended ceilings, recessed lighting and, perimeter trunking. The suite includes a small kitchen, comms room and 2 office/meeting rooms. Access is via either the main reception or the Bruton Street lifts which are immediately adjacent to the suite.

### FLOOR AREA

FLOOR	SQ FT	SQ M
Suite I, 6th Floor	4,596	426.9

Cushman & Wakefield have not tested any of the services or equipment within the property. Lessee's may wish to make their own investigations.

The Code for Leasing Business Premises in England and Wales recommends you seek professional advice before agreeing a business tenancy. Details available from [www.leasebusinesspremisses.co.uk](http://www.leasebusinesspremisses.co.uk)

Copies of the Code may be obtained from the Royal Institution of Chartered Surveyors, telephone 020 7334 3806 or from the website at [www.commercialleasecodeew.co.uk](http://www.commercialleasecodeew.co.uk)

MISREPRESENTATION ACT 1967 and PROPERTY MISDESCRIPTIONS ACT 1991

Cushman & Wakefield LLP, their clients and any joint agents, give notice that: (i) These particulars do not form part of any offer or contract and must not be relied upon as statements or representations of fact. (ii) No person in the employment of the agent(s) has any authority to make or give any representation or warranty whatever in relation to this property. (iii) Floor areas, measurements or distances given are approximate. Unless otherwise stated, any rents, or outgoings quoted are exclusive of VAT. (iv) Any descriptions given on the property cannot be taken to imply, it is in good repair, has all necessary consents, is free of contamination, or that the services and facilities are in working order. Interested parties are advised to carry out their own investigations as required.

Printed by PS2 Property Templates [www.ps2property.co.uk](http://www.ps2property.co.uk)

### TERMS

The suite is available on flexible terms on either a traditional sub-lease or an inclusive package through until November 2011.

### RENT

£52.50 per sq ft per annum exclusive

### ESTIMATED RATES

£16.50 per sq ft

### ESTIMATED SERVICE CHARGE

£13.50 per sq ft

### VIEWING

Strictly by appointment only

### ANDY TYLER

Tel: 020 7152 5250

[andy.tyler@eur.cushwake.com](mailto:andy.tyler@eur.cushwake.com)

### LEON BALLARD

Tel: 020 7152 5031

[leon.ballard@eur.cushwake.com](mailto:leon.ballard@eur.cushwake.com)

020 7935 5000  
[www.cushmanwakefield.com](http://www.cushmanwakefield.com)  
43/45 Portman Square  
London, W1A 3BG