

FOR SALE - OFFICE DEVELOPMENT PLOTS, SOPWITH CLOSE/BOEING WAY, PRESTON FARM BUSINESS PARK, STOCKTON ON TEES, TS18 3TT



LOCATION

Preston Farm Business Park is one of Teesside's Premier Business locations lying adjacent to the A66 Trunk Road which links with the A19 and A1(M) respectively.

The plots are prominently located close to the corner of Boeing Way and Sopwith Close, a short distance from the Thornaby Bypass which provides a direct link between Ingleby Barwick Housing Estate and Stockton Town Centre.

Preston Farm Business park has been developed over a number of years to become one of the region's premier commercial locations. The estate accommodates a number of recognised companies including Makro, Virgin Media, Audi, Mercedes and BMW.

DESCRIPTION

The plots are fully serviced with external car park, drainage and site infrastructure already in situ.

The Planning Consent should allow for office of approximately 4,750-5,000 sq ft GIA with associated car parking.

Robert House Westpoint Road Teesdale Business Park Stockton on Tees TS17 6BA

01642 426 900 Fax 01642 426 999 sandersonweatherall.com

LEEDS LONDON NEWCASTLE MANCHESTER TEESIDE

Chartered surveyors and property consultants

Note: For conditions under which particulars are issued see over



PLANNING

Detailed planning consent has been granted for the construction of 2 detached two-storey office buildings with a footprint of approximately 2,550 sq ft GEA and 2,575 sq ft GEA. A copy of the planning consent can be provided upon request or alternatively we recommend that interested parties speak with the Planning Department at Stockton Borough Council.

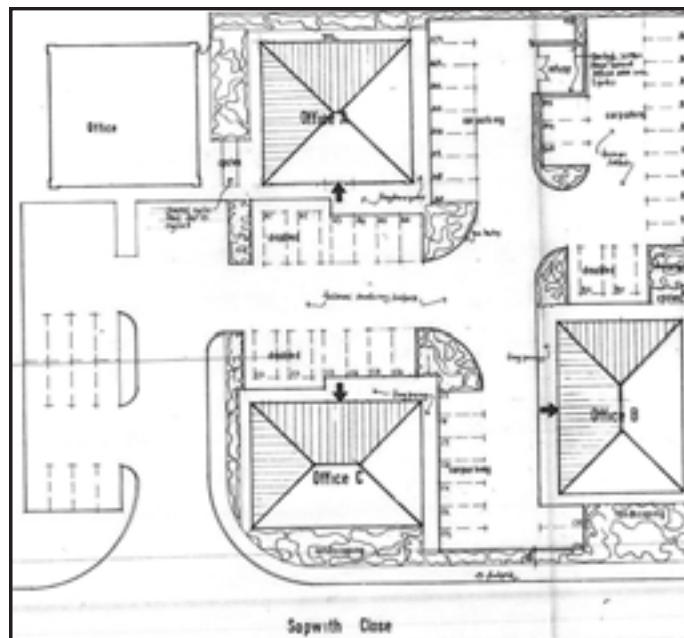

Indicative Plan

TERMS

The plots are offered For Sale with the benefit of the existing planning consents and offers in the region of £150,000 per plot are invited.

FURTHER INFORMATION/VIEWING

Please contact

Tim Carter ddl:- 01642 426919

Email tim.carter@sandersonweatherall.com

David Jackson ddl:- 01642 426914

Email: david.jackson@sandersonweatherall.com

www.sandersonweatherall.com

Misrepresentation Act 1967:

Sanderson Weatherall LLP for itself and for the vendor(s) or lessor(s) of this property whose agent it is give notice that:-

- 1 These particulars do not constitute any part of an offer or contract.
- 2 None of the statements contained in these particulars as to the property(s) are to be relied on as statements or representations of fact.
- 3 Any intending purchasers must satisfy themselves by inspection or otherwise as to the correctness of each of the statements contained in these particulars.
- 4 The vendor(s) or lessor(s) do not make or give and neither Sanderson Weatherall LLP nor any person in its employment has any authority to make or give any representation or warranty whatsoever in relation to the property.
- 5 None of the buildings services or service installations (whether these be the specific responsibility of the freeholder, lessor or lessee) have been tested and are not warranted to be in safe working order.

Finance Act 1989:

Unless otherwise stated all prices and rents are quoted exclusive of V.A.T.

Property Misdescriptions Act 1991

Every reasonable effort has been made by Sanderson Weatherall LLP to ensure accuracy. Interested parties are strongly advised to take appropriate steps to verify by independent inspection or enquiry all information for themselves and to take appropriate professional advice.

Sanderson Weatherall LLP

Registered In England company number OC 344 770.
Registered Office 25 Wellington Street Leeds LS1 4WG.